

入力データ 図枠(800 25 300 300)

節点数= 15
要素数= 21

節点番号	x座標	y座標	x拘束	y拘束	回転拘束	x荷重	y荷重	M荷重
1	0	0	1	1	0	0	0	0
2	72.85	0	1	1	0	0	0	0
3	145.6	0	1	1	0	0	0	0
4	218.45	0	1	1	0	0	0	0
5	0	50	0	0	0	0	0	0
6	72.85	50	0	0	0	0	0	0
7	145.6	50	0	0	0	0	0	0
8	218.45	50	0	0	0	0	0	0
9	0	100	0	0	0	10	0	0
10	72.85	100	0	0	0	0	0	0
11	145.6	100	0	0	0	0	0	0
12	218.45	100	0	0	0	0	0	0
13	72.85	146.688	0	0	0	0	0	0
14	145.6	146.688	0	0	0	0	0	0
15	109.225	170	0	0	0	0	0	0

要素番号	節点1	節点2	E	A	I	wxi	wxj	wyi	wyj	Z	F
1	1	5	400	64	341.3	0	0	0	0	85.33	1.6
2	5	9	400	64	341.3	0	0	0	0	85.33	1.6
3	4	8	400	64	341.3	0	0	0	0	85.33	1.6
4	8	12	400	64	341.3	0	0	0	0	85.33	1.6
5	2	6	400	64	341.3	0	0	0	0	85.33	1.6
6	6	10	400	64	341.3	0	0	0	0	85.33	1.6
7	10	14	400	64	341.3	0	0	0	0	85.33	1.6
8	3	7	400	64	341.3	0	0	0	0	85.33	1.6
9	7	11	400	64	341.3	0	0	0	0	85.33	1.6
10	11	15	400	64	341.3	0	0	0	0	85.33	1.6
11	5	9	400	64	341.3	0	0	0	0	85.33	1.6
12	9	13	400	64	341.3	0	0	0	0	85.33	1.6
13	13	17	400	64	341.3	0	0	0	0	85.33	1.6
14	7	11	400	64	341.3	0	0	0	0	85.33	1.6
15	11	15	400	64	341.3	0	0	0	0	85.33	1.6
16	15	19	400	64	341.3	0	0	0	0	85.33	1.6
17	19	23	400	64	341.3	0	0	0	0	85.33	1.6
18	13	17	400	64	341.3	0	0	0	0	85.33	1.6
19	17	21	400	64	341.3	0	0	0	0	85.33	1.6
20	11	15	400	64	341.3	0	0	0	0	85.33	1.6
21	15	19	400	64	341.3	0	0	0	0	85.33	1.6

単位系
力:N
長さ:mm

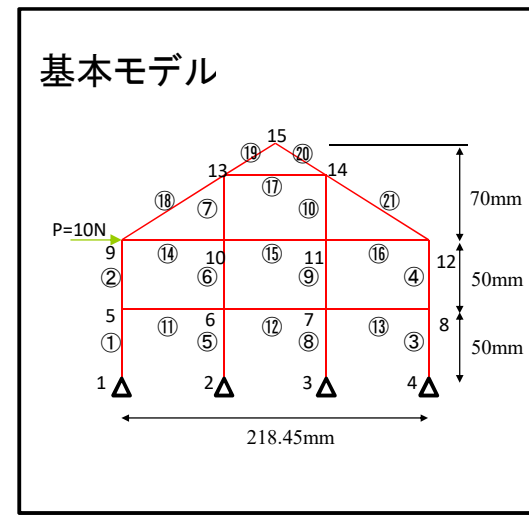

假定断面
柱

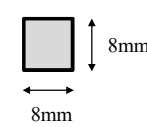

断面積A 64 mm²
断面2次モーメントI 341.3 mm⁴
断面係数Z 85.33 mm³
ヤング係数E 400 N/mm²
基準強度F 1.6 N/mm²

梁

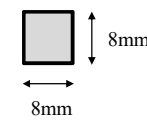

断面積A 64 mm²
断面2次モーメントI 341.3 mm⁴
断面係数Z 85.33 mm³
ヤング係数E 400 N/mm²
基準強度F 1.6 N/mm²

出力データ

節点番号	u	v	θ
1	0	0	-0.03254
2	0	0	-0.03472
3	0	0	-0.03473
4	0	0	-0.03264
5	1.301479	0.008342	-0.013
6	1.302424	-0.0015	-0.0087
7	1.301881	0.004786	-0.00866
8	1.300172	-0.01163	-0.01272
9	1.876241	0.010223	-0.00449
10	1.855656	-0.00183	-0.00316
11	1.84613	0.00856	-0.00317
12	1.847357	-0.01695	-0.00436
13	1.880427	-0.00195	0.000726
14	1.87633	0.012029	0.000474
15	1.873784	0.008137	-9.8E-06

$=\text{MAX}(\text{ABS}(F66/K24), \text{ABS}(G66/K24))$

$=\text{ABS}(B66/E24)$

$=I66+J66$

$=K66/L2$

要素番号	Ni	Nj	Qi	Qj	Mi	Mj	軸方向応力度 曲げ応力度 最大応力度 応力度比			
							σ N	σ M	σ max	γ
1	4.270894	4.270894	2.134579	2.134579	0	106.7289	0.067	1.251	1.317	0.823
2	0.963334	0.963334	1.80242	1.80242	-21.8162	68.3048	0.015	0.800	0.815	0.510
3	-5.95548	-5.95548	2.175763	2.175763	0	108.7881	0.093	1.275	1.368	0.855
4	-2.72392	-2.72392	1.575207	1.575207	-16.5327	62.22764	0.043	0.729	0.772	0.482
5	-0.76562	-0.76562	2.842919	2.842919	0	142.1459	0.012	1.666	1.678	1.049
6	-0.1717	-0.1717	3.366307	3.366307	-69.0373	99.27805	0.003	1.163	1.166	0.729
7	-0.06623	-0.06623	-0.51563	-0.51563	23.40023	-0.67367	0.001	0.274	0.275	0.172
8	2.45021	2.45021	2.84674	2.84674	0	142.337	0.038	1.668	1.706	1.066
9	1.932286	1.932286	3.256067	3.256067	-66.4056	96.39775	0.030	1.130	1.160	0.725
10	1.902499	1.902499	-0.52713	-0.52713	22.96528	-1.64514	0.030	0.269	0.299	0.187
11	0.332159	0.332159	-3.30756	-3.30756	128.5451	-112.411	0.005	1.506	1.512	0.945
12	-0.19123	-0.19123	-2.71364	-2.71364	98.77266	-98.6443	0.003	1.157	1.160	0.725
13	-0.60056	-0.60056	-3.23156	-3.23156	110.0983	-125.321	0.009	1.469	1.478	0.924
14	-7.23396	-7.23396	-1.12949	-1.12949	43.63329	-38.6503	0.113	0.511	0.624	0.390
15	-3.35202	-3.35202	-1.02402	-1.02402	37.22751	-37.27	0.052	0.437	0.489	0.306
16	0.431174	0.431174	-1.05381	-1.05381	36.16244	-40.6075	0.007	0.476	0.483	0.302
17	-1.44182	-1.44182	0.126366	0.126366	-5.06911	4.124015	0.023	0.059	0.082	0.051
18	-0.90096	-0.90096	-0.38005	-0.38005	24.6715	-8.21339	0.014	0.289	0.303	0.189
19	-0.08872	-0.08872	0.069062	0.069062	-3.81795	-0.83419	0.001	0.045	0.046	0.029
20	0.025688	0.025688	0.10946	0.10946	-0.83419	3.894913	0.000	0.046	0.046	0.029
21	-2.5904	-2.5904	-0.32353	-0.32353	6.373784	-21.6201	0.040	0.253	0.294	0.184

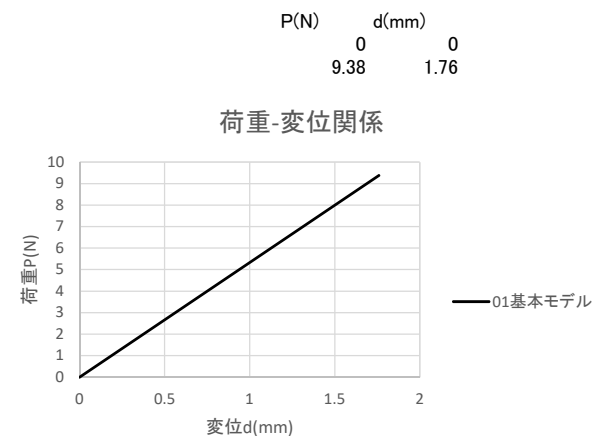

節点番号	Rx	Ry	Rm
1	-2.13458	-4.27089	
2	-2.84292	0.765622	
3	-2.84674	-2.45021	
4	-2.17576	5.955482	

$=\text{ABS}(G15)/\text{MAX}(L66:L86)$

$=\text{ABS}(B57)/\text{MAX}(L66:L86)$

最大耐力 9.38 N

最大変位 1.76 mm

保有水平耐力(1構面あたり)
10 N 以下(NG)